

CAPITOL ACCESSIBILITY GUIDE

- PRIMARY ACCESSIBLE ROUTES
- CURB RAMPS

All Capitol, Capitol Extension and Capitol Visitors Center facilities are accessible to persons with disabilities. For special assistance, contact the Capitol Information and Guide Service at 463-0063, or visit their office in the Capitol, First Floor, South Wing. Watch for oval-shaped signs on the Capitol Grounds which indicate accessible routes. Vehicles properly displaying an official disabled parking placard or disabled parking license plate may park at any State of Texas controlled parking meter in the Capitol Complex for free at any time. Accessible parking is also available in the Capitol Visitors Parking Garage.

Extension First Floor (E1)

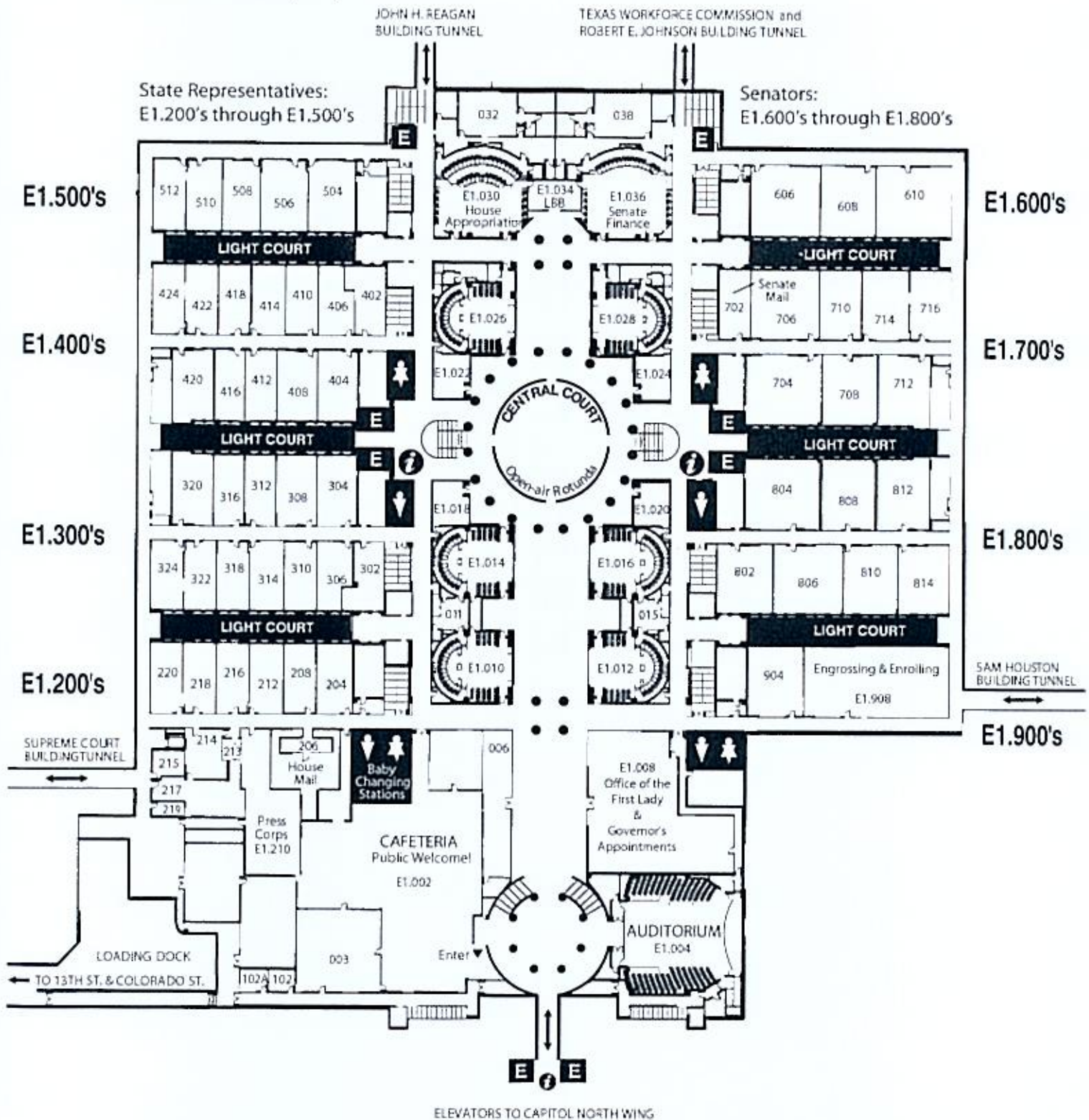

Capitol Extension Guide
Floor E1

Extension Second Floor (E2)

State Representatives Offices
E2.200 through E2.900's

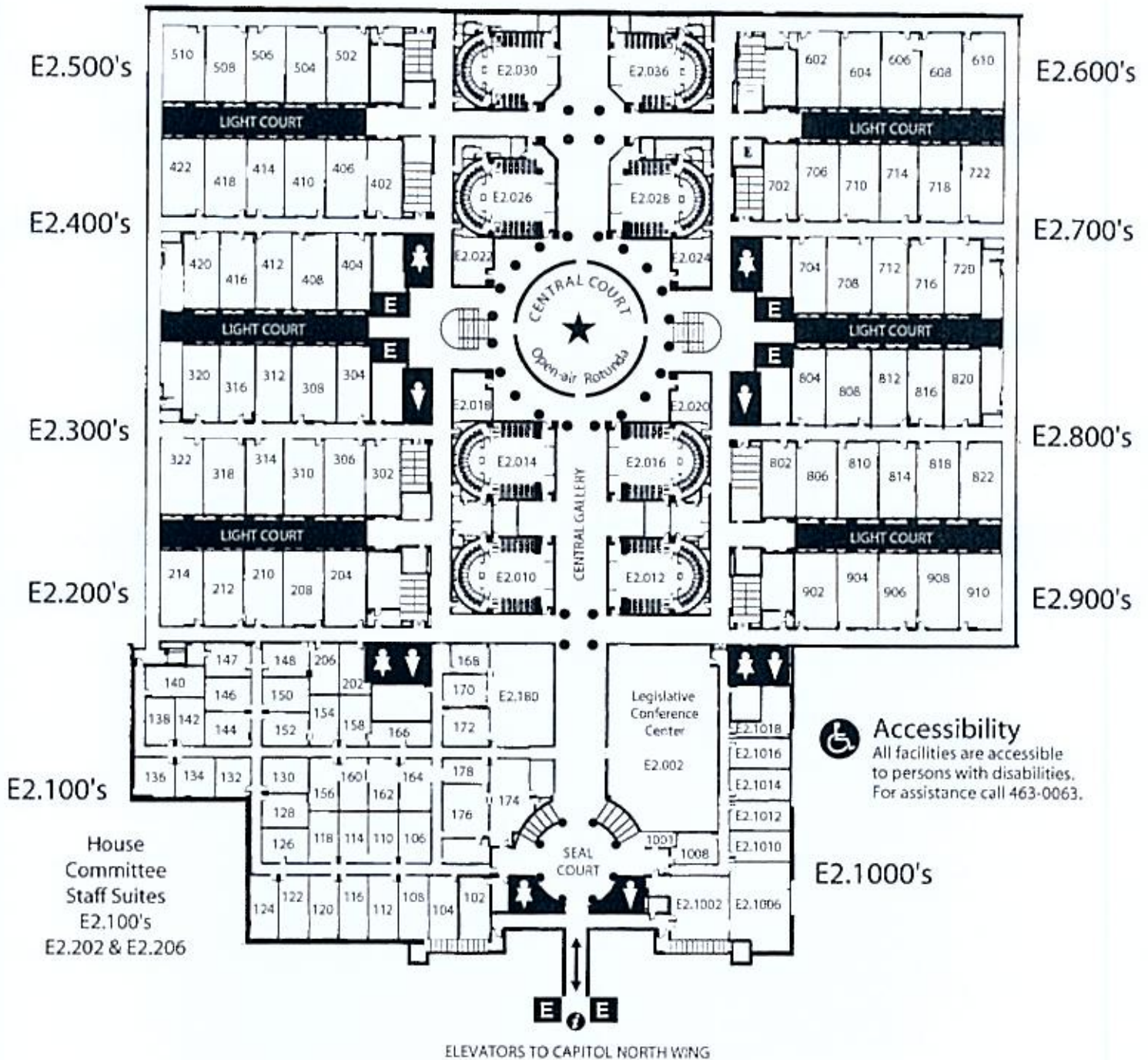

Capitol Extension Guide Floor E2

Second Floor

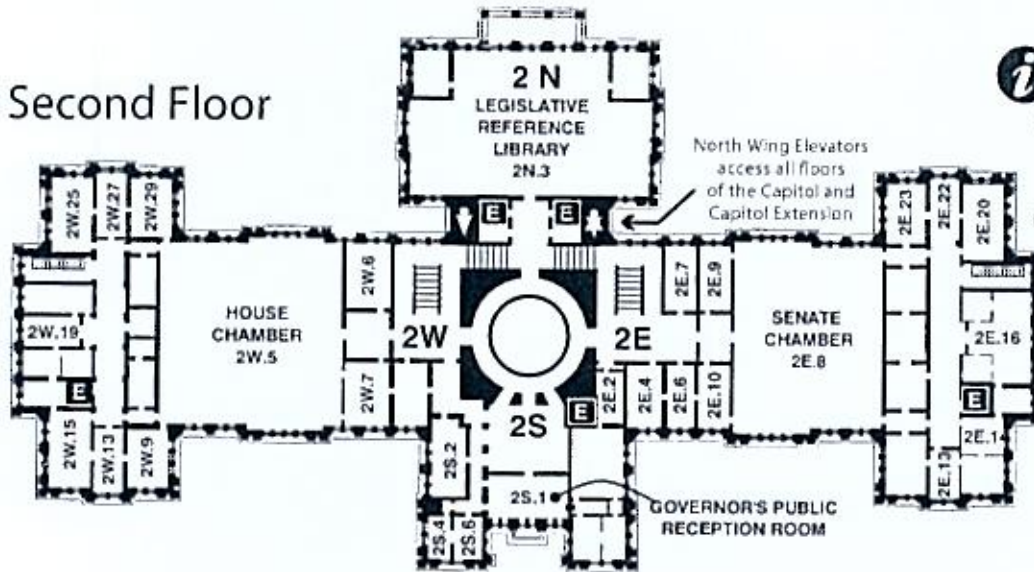

INFORMATION & TOURS

Monday - Friday, 8:30 am - 4:30 pm

Saturday, 9:30 am - 3:30 pm

Sunday, Noon - 3:30 pm

Call 463-0063 for more information

Capitol Extension Access: Take the North Wing elevators to Floor E1 or E2 of the underground Capitol Extension. Please visit the Capitol Giftshop on Floor E1 for Texas and Capitol mementos and books, as well as mints, medicines, and other sundries. Also located on level E1 are a public cafeteria, an Automatic Teller Machine (ATM) and vending machines.

Fourth Floor

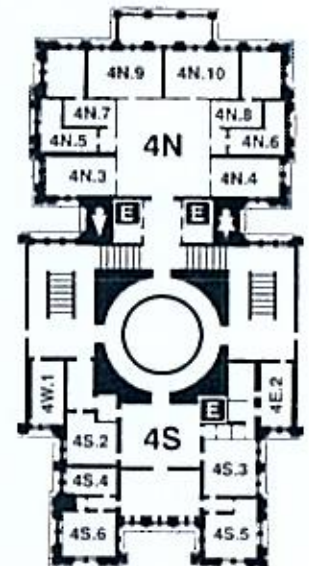

Third Floor

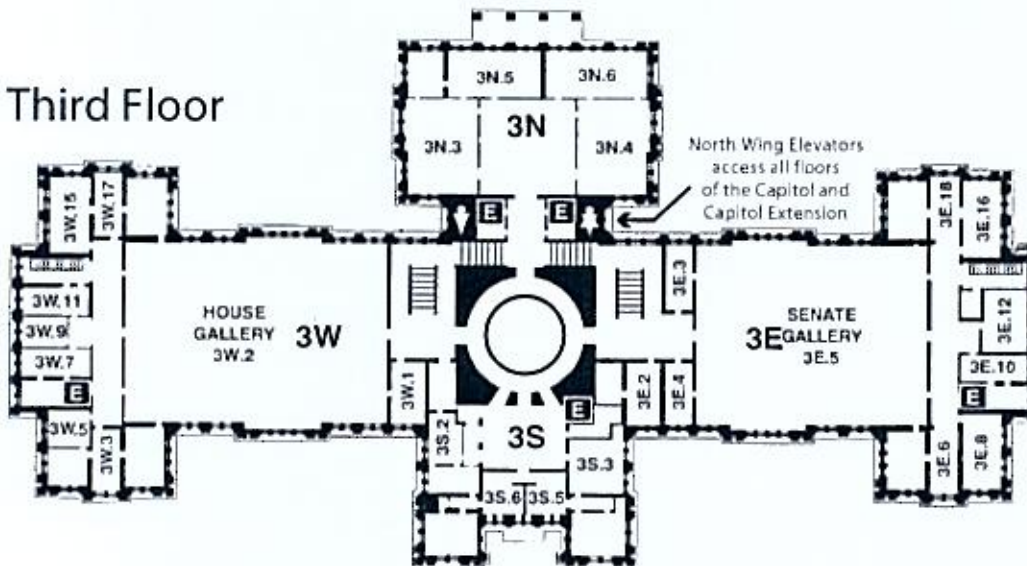

ACCESSIBILITY

All facilities are accessible to persons with disabilities. For assistance call 463-0063.

CAPITOL BUILDING GUIDE

FLOORS 2, 3, & 4

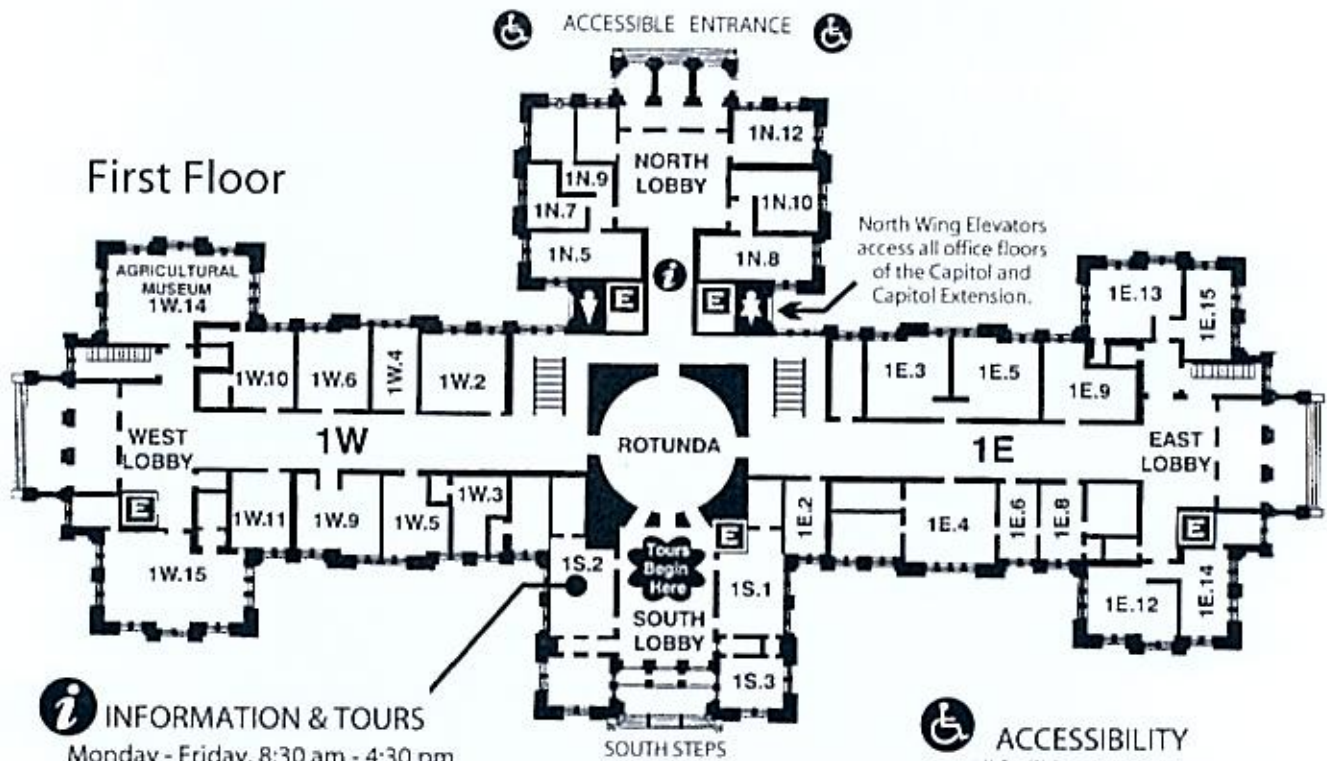

i INFORMATION & TOURS
 Monday - Friday, 8:30 am - 4:30 pm
 Saturday 9:30 am - 3:30 pm
 Sunday, Noon - 3:30 pm
 Call 463-0063 for more information

♿ ACCESSIBILITY
 All facilities are accessible
 to persons with disabilities.
 For assistance call 463-0063.

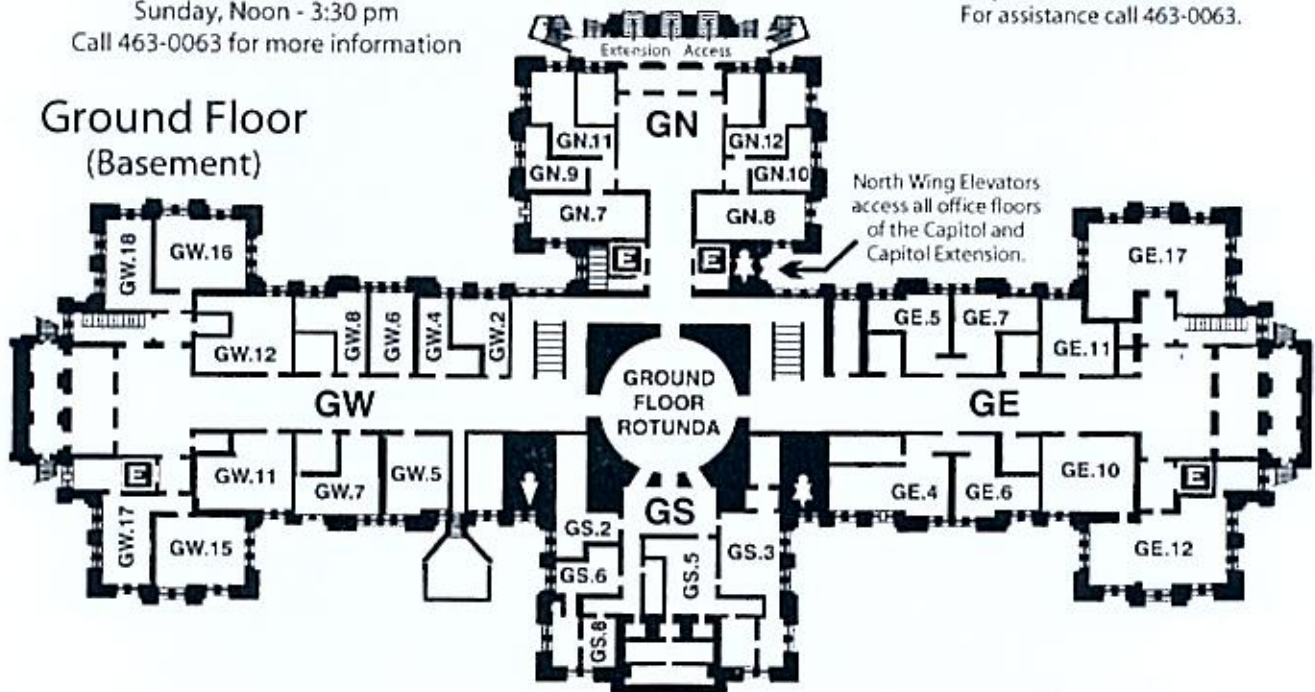

CAPITOL BUILDING GUIDE

FLOORS 1 & GROUND